

DEFLECTION ANGLE

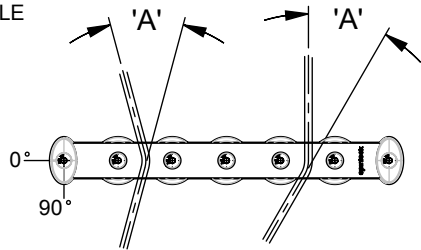

BISECTED ROPE ENTRY

STRAIGHT ROPE ENTRY

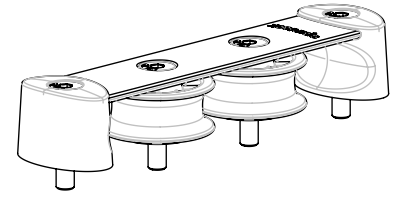

DEFLECTION ANGLE, 'A' (°)	MAX ROPE TENSION (KG)
10	3440
15	2300
30	1160
45	780
60	600
90	420

Ø 38 COMPOSITE SHEAVE (T38/2)
ALLOY SHEAVE (T38/2A)

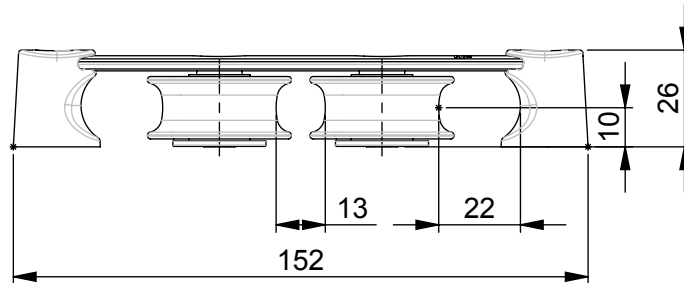
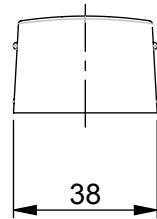
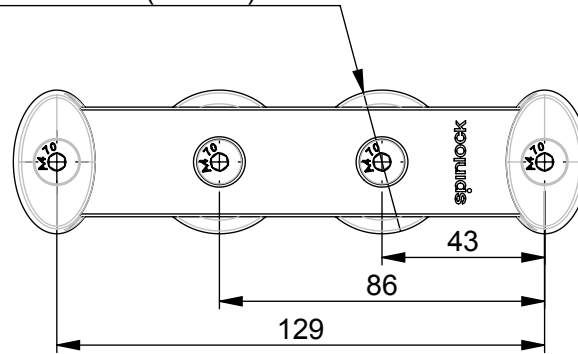

spinlock
BE ADVENTURE-PROOF



WARNING:
IF USING AS DRILL TEMPLATE, ENSURE PRINTER SETTINGS ARE ADJUSTED TO ACCOUNT FOR THE DRAWING SCALE AND **ALWAYS** CHECK DIMENSIONS BEFORE DRILLING.



COPYRIGHT:
THIS DRAWING IS PROTECTED BY COPYRIGHT. ANY USE IS FORBIDDEN WITHOUT THE WRITTEN CONSENT OF SPINLOCK.

ALL DIMENSIONS IN MM

SCALE PAGE SIZE DATE

1:2

A4

MAR 2018

LINE SIZE:
6-12mm
FASTENERS
M6 CSK
x 4

PRODUCT CODE

T38/2
T38/2A

WEIGHT

115g
154g

MAX LOAD

600kg
600kg

MAX LOAD PER UNIT

600kg
600kg

T38/2

FOR ANY MORE INFO CONTACT
SPT@SPINLOCK.CO.UK

DEFLECTION ANGLE

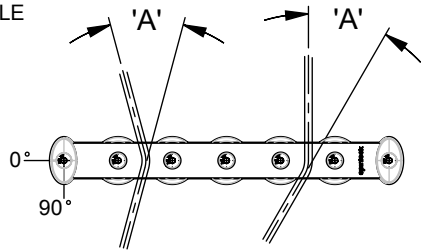

BISECTED ROPE ENTRY

STRAIGHT ROPE ENTRY

DEFLECTION ANGLE, 'A' (°)	MAX ROPE TENSION (KG)
10	3440
15	2300
30	1160
45	780
60	600
90	420

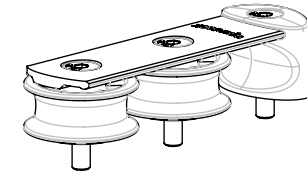

Ø38 COMPOSITE SHEAVE (T38/2Y)
ALLOY SHEAVE (T38/2YA)

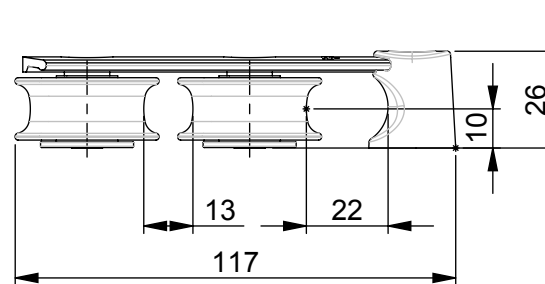
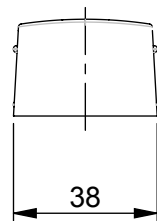
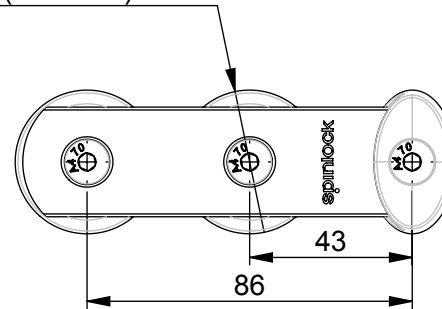

spinlock
BE ADVENTURE-PROOF



WARNING:
IF USING AS DRILL TEMPLATE, ENSURE PRINTER SETTINGS ARE ADJUSTED TO ACCOUNT FOR THE DRAWING SCALE AND **ALWAYS** CHECK DIMENSIONS BEFORE DRILLING.



COPYRIGHT:
THIS DRAWING IS PROTECTED BY COPYRIGHT. ANY USE IS FORBIDDEN WITHOUT THE WRITTEN CONSENT OF SPINLOCK.

ALL DIMENSIONS IN MM

SCALE PAGE SIZE DATE

1:2

A4

MAR 2018

LINE SIZE:
6-12mm
FASTENERS
M6 CSK
x 3

PRODUCT CODE

T38/2Y

T38/2YA

WEIGHT

94g

133g

MAX LOAD

600kg

600kg

MAX LOAD PER UNIT

600kg

600kg

T38/2Y

FOR ANY MORE INFO CONTACT
SPT@SPINLOCK.CO.UK

DEFLECTION ANGLE

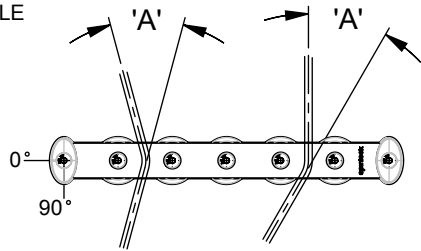

BISECTED
ROPE ENTRY

STRAIGHT
ROPE ENTRY

DEFLECTION ANGLE, 'A' (°)	MAX ROPE TENSION (KG)
10	3440
15	2300
30	1160
45	780
60	600
90	420

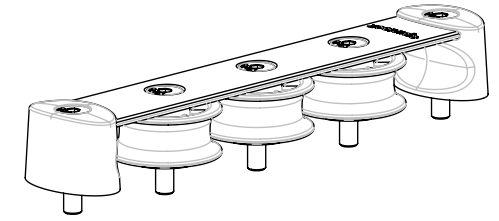

Ø 38 COMPOSITE SHEAVE (T38/3)
ALLOY SHEAVE (T38/3A)

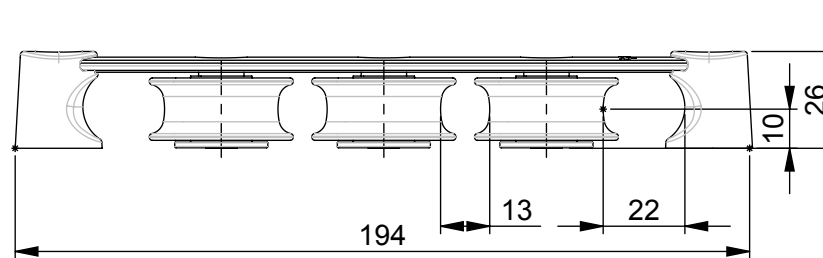
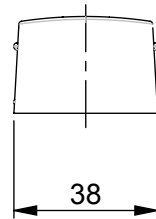
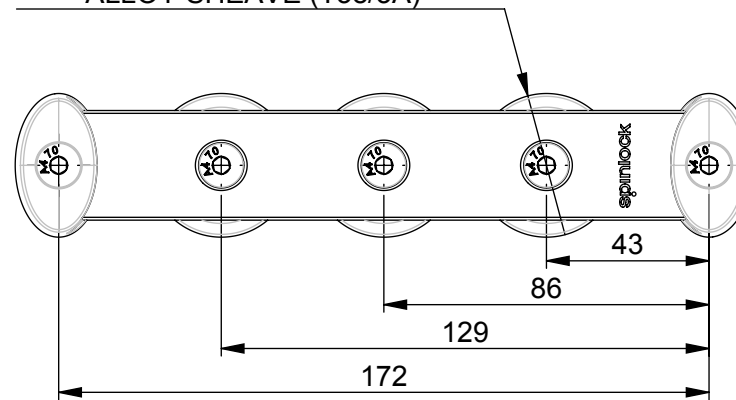

spinlock
BE ADVENTURE-PROOF



WARNING:
IF USING AS DRILL TEMPLATE, ENSURE PRINTER SETTINGS ARE ADJUSTED TO ACCOUNT FOR THE DRAWING SCALE AND **ALWAYS** CHECK DIMENSIONS BEFORE DRILLING.



COPYRIGHT:
THIS DRAWING IS PROTECTED BY COPYRIGHT. ANY USE IS FORBIDDEN WITHOUT THE WRITTEN CONSENT OF SPINLOCK.

ALL DIMENSIONS IN MM

SCALE PAGE SIZE DATE

1:2

A4

MAR
2018

LINE SIZE:
6-12mm
FASTENERS
M6 CSK
x 5

PRODUCT CODE

T38/3

T38/3A

WEIGHT

154g

212g

MAX LOAD

600kg

600kg

MAX LOAD PER UNIT

900kg

900kg

T38/3

FOR ANY MORE INFO CONTACT
SPT@SPINLOCK.CO.UK

DEFLECTION ANGLE

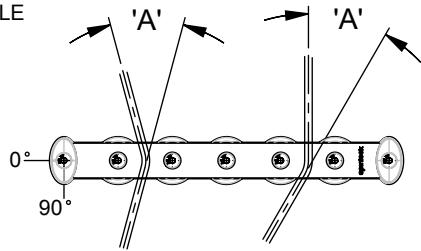

BISECTED ROPE ENTRY

STRAIGHT ROPE ENTRY

DEFLECTION ANGLE, 'A' (°)	MAX ROPE TENSION (KG)
10	3440
15	2300
30	1160
45	780
60	600
90	420

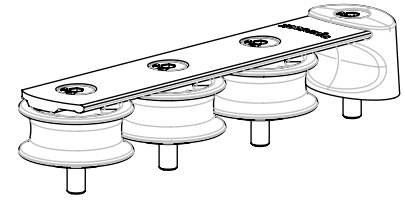

Ø 38 COMPOSITE SHEAVE (T38/3Y)
ALLOY SHEAVE (T38/3YA)

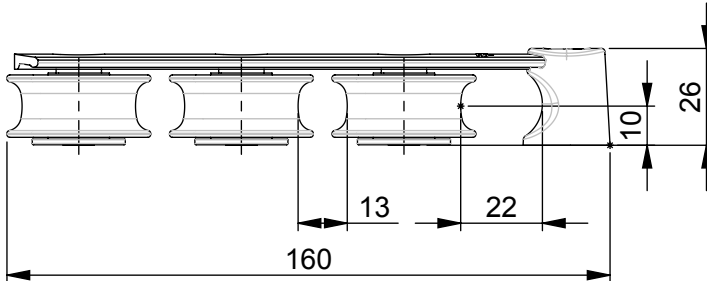
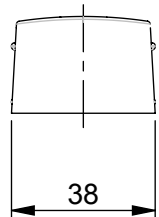
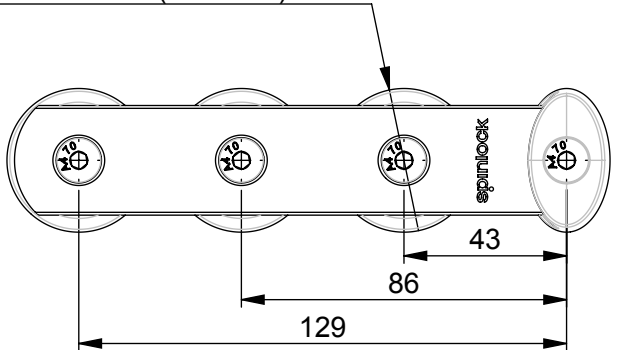

spinlock
BE ADVENTURE-PROOF



WARNING:
IF USING AS DRILL TEMPLATE, ENSURE PRINTER SETTINGS ARE ADJUSTED TO ACCOUNT FOR THE DRAWING SCALE AND **ALWAYS** CHECK DIMENSIONS BEFORE DRILLING.



COPYRIGHT:
THIS DRAWING IS PROTECTED BY COPYRIGHT. ANY USE IS FORBIDDEN WITHOUT THE WRITTEN CONSENT OF SPINLOCK.

ALL DIMENSIONS IN MM

SCALE PAGE SIZE DATE

1:2 A4 MAR 2018

LINE SIZE:
6-12mm
FASTENERS
M6 CSK
x 4

PRODUCT CODE	WEIGHT	MAX LOAD	MAX LOAD PER UNIT
T38/3Y	134g	600kg	900kg
T38/3YA	191g	600kg	900kg

T38/3Y

FOR ANY MORE INFO CONTACT
SPT@SPINLOCK.CO.UK

DEFLECTION ANGLE

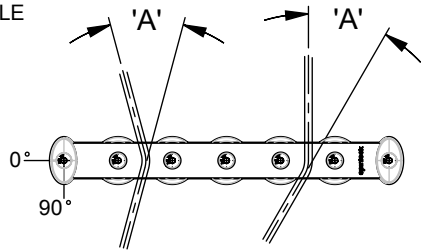

BISECTED
ROPE ENTRY

STRAIGHT
ROPE ENTRY

DEFLECTION ANGLE, 'A' (°)	MAX ROPE TENSION (KG)
10	3440
15	2300
30	1160
45	780
60	600
90	420

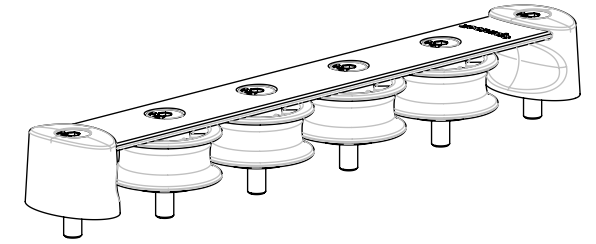

Ø38 COMPOSITE SHEAVE (T38/4)
ALLOY SHEAVE (T38/4A)

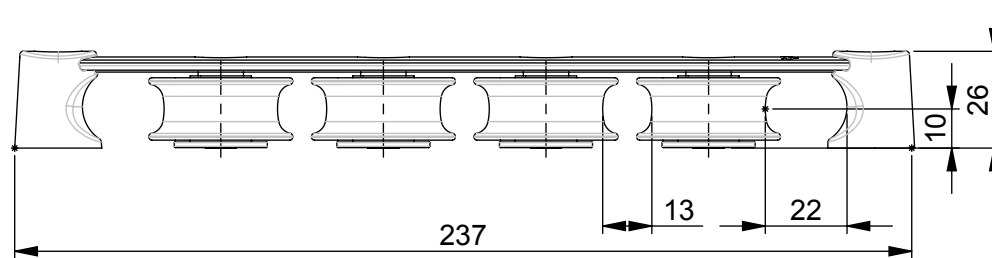
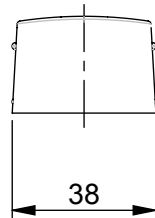
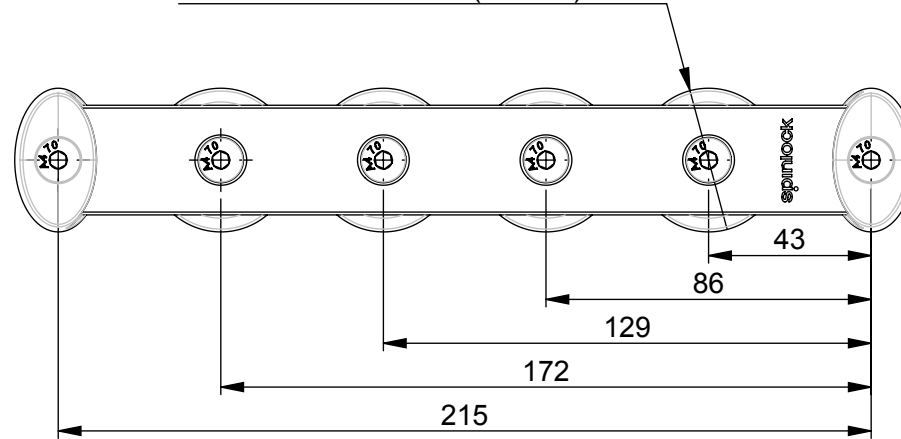

spinlock
BE ADVENTURE-PROOF



WARNING:
IF USING AS DRILL TEMPLATE, ENSURE PRINTER SETTINGS ARE ADJUSTED TO ACCOUNT FOR THE DRAWING SCALE AND **ALWAYS** CHECK DIMENSIONS BEFORE DRILLING.



COPYRIGHT:
THIS DRAWING IS PROTECTED BY COPYRIGHT. ANY USE IS FORBIDDEN WITHOUT THE WRITTEN CONSENT OF SPINLOCK.

ALL DIMENSIONS IN MM

SCALE PAGE SIZE DATE

1:2

A4

MAR
2018

LINE SIZE:
6-12mm
FASTENERS
M6 CSK
x 6

PRODUCT CODE

T38/4

T38/4A

WEIGHT

190g

267g

MAX LOAD

600kg

600kg

MAX LOAD PER UNIT

1200kg

1200kg

T38/4

FOR ANY MORE INFO CONTACT
SPT@SPINLOCK.CO.UK

DEFLECTION ANGLE

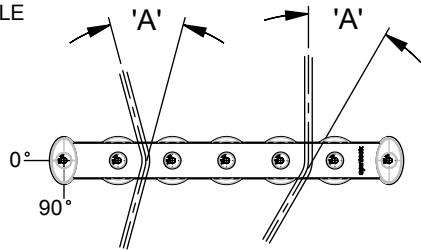

BISECTED ROPE ENTRY

STRAIGHT ROPE ENTRY

DEFLECTION ANGLE, 'A' (°)	MAX ROPE TENSION (KG)
10	3440
15	2300
30	1160
45	780
60	600
90	420

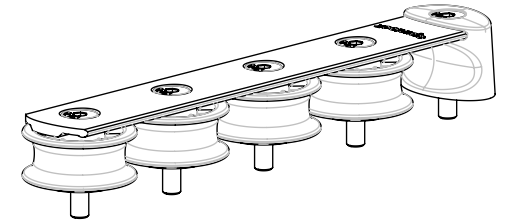

Ø38 COMPOSITE SHEAVE (T38/4Y)
ALLOY SHEAVE (T38/4YA)

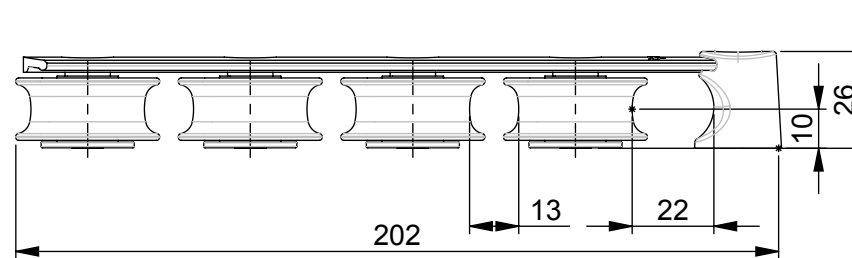
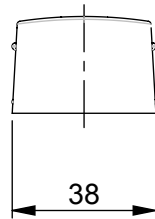
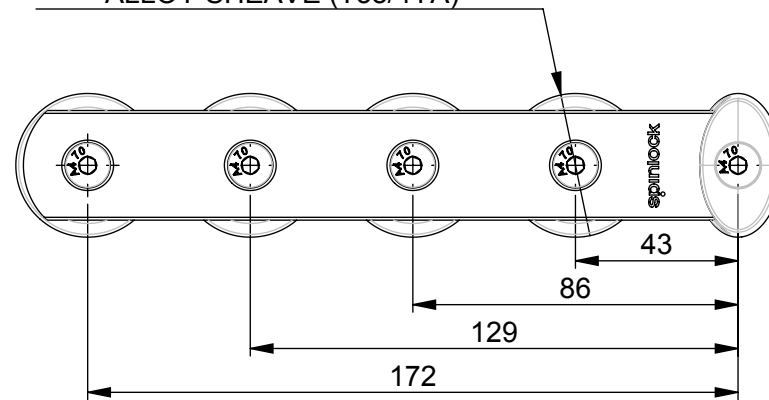

spinlock
BE ADVENTURE-PROOF



WARNING:
IF USING AS DRILL TEMPLATE, ENSURE PRINTER SETTINGS ARE ADJUSTED TO ACCOUNT FOR THE DRAWING SCALE AND **ALWAYS** CHECK DIMENSIONS BEFORE DRILLING.



COPYRIGHT:
THIS DRAWING IS PROTECTED BY COPYRIGHT. ANY USE IS FORBIDDEN WITHOUT THE WRITTEN CONSENT OF SPINLOCK.

ALL DIMENSIONS IN MM

SCALE PAGE SIZE DATE

1:2

A4

MAR 2018

LINE SIZE:
6-12mm
FASTENERS
M6 CSK
x 5

PRODUCT CODE

T38/4Y

T38/4YA

WEIGHT

170g

247g

MAX LOAD

600kg

600kg

MAX LOAD PER UNIT

1200kg

1200kg

T38/4Y

FOR ANY MORE INFO CONTACT
SPT@SPINLOCK.CO.UK

DEFLECTION ANGLE

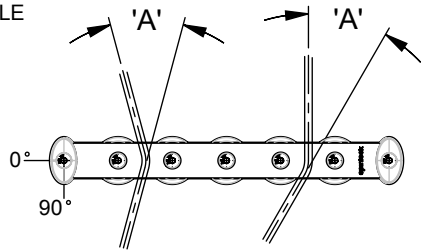

BISECTED ROPE ENTRY

STRAIGHT ROPE ENTRY

DEFLECTION ANGLE, 'A' (°)	MAX ROPE TENSION (KG)
10	3440
15	2300
30	1160
45	780
60	600
90	420

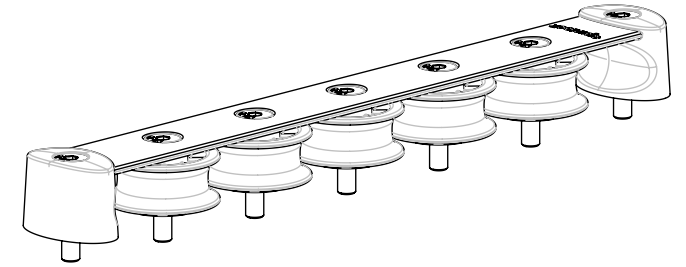

Ø 38 COMPOSITE SHEAVE (T38/5)
ALLOY SHEAVE (T38/5A)

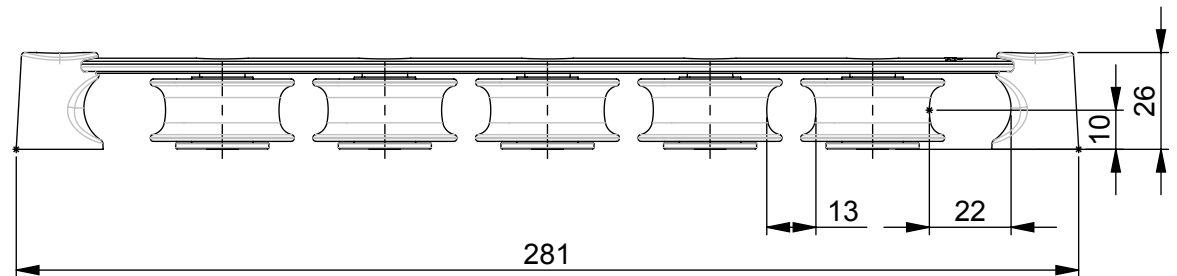
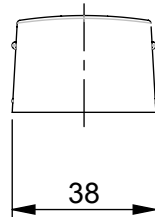
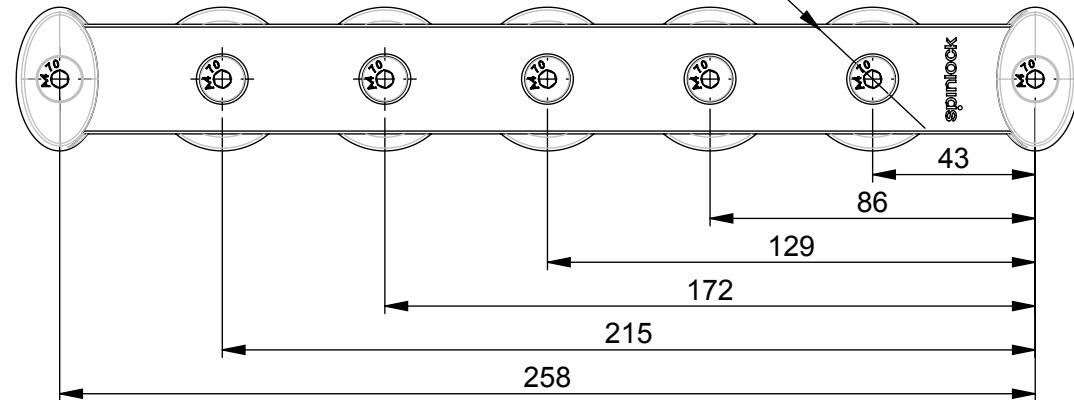

spinlock
BE ADVENTURE-PROOF



WARNING:
IF USING AS DRILL TEMPLATE, ENSURE PRINTER SETTINGS ARE ADJUSTED TO ACCOUNT FOR THE DRAWING SCALE AND **ALWAYS** CHECK DIMENSIONS BEFORE DRILLING.



COPYRIGHT:
THIS DRAWING IS PROTECTED BY COPYRIGHT. ANY USE IS FORBIDDEN WITHOUT THE WRITTEN CONSENT OF SPINLOCK.

ALL DIMENSIONS IN MM

SCALE PAGE SIZE DATE

1:2

A4

MAR 2018

LINE SIZE:
6-12mm
FASTENERS
M6 CSK
x 7

PRODUCT CODE

T38/5

T38/5A

WEIGHT

227g

323g

MAX LOAD

600kg

600kg

MAX LOAD PER UNIT

1500kg

1500kg

T38/5

FOR ANY MORE INFO CONTACT
SPT@SPINLOCK.CO.UK

DEFLECTION ANGLE

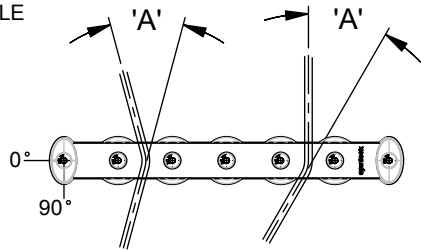

BISECTED ROPE ENTRY

STRAIGHT ROPE ENTRY

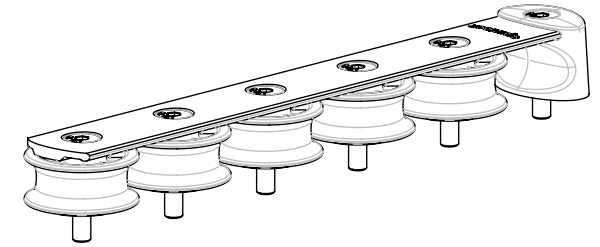

DEFLECTION ANGLE, 'A' (°)	MAX ROPE TENSION (KG)
10	3440
15	2300
30	1160
45	780
60	600
90	420

Ø38 COMPOSITE SHEAVE (T38/5Y)
ALLOY SHEAVE (T38/5YA)

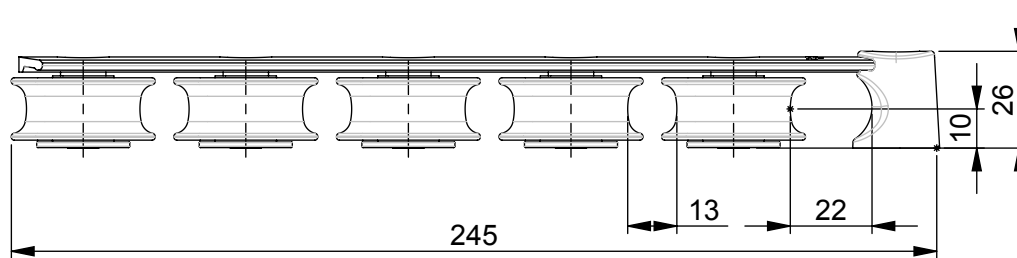
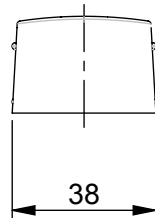
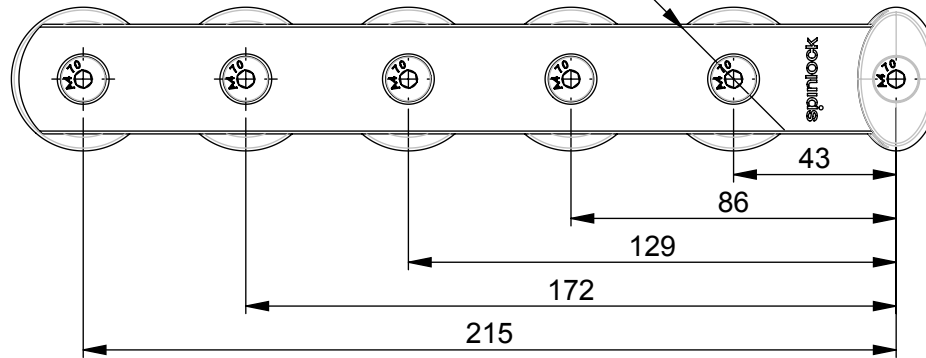

spinlock
BE ADVENTURE-PROOF



WARNING:
IF USING AS DRILL TEMPLATE, ENSURE PRINTER SETTINGS ARE ADJUSTED TO ACCOUNT FOR THE DRAWING SCALE AND **ALWAYS** CHECK DIMENSIONS BEFORE DRILLING.



COPYRIGHT:
THIS DRAWING IS PROTECTED BY COPYRIGHT. ANY USE IS FORBIDDEN WITHOUT THE WRITTEN CONSENT OF SPINLOCK.

ALL DIMENSIONS IN MM

SCALE PAGE SIZE DATE

1:2

A4

MAR
2018

LINE SIZE:
6-12mm
FASTENERS
M6 CSK
x 6

PRODUCT CODE

T38/5Y

T38/5YA

WEIGHT

207g

303g

MAX LOAD

600kg

600kg

MAX LOAD PER UNIT

1500kg

1500kg

T38/5Y

FOR ANY MORE INFO CONTACT
SPT@SPINLOCK.CO.UK

DEFLECTION ANGLE

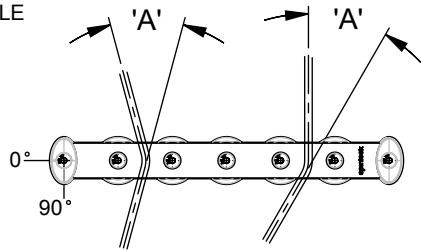

BISECTED ROPE ENTRY

STRAIGHT ROPE ENTRY

DEFLECTION ANGLE, 'A' (°)	MAX ROPE TENSION (KG)
10	3440
15	2300
30	1160
45	780
60	600
90	420

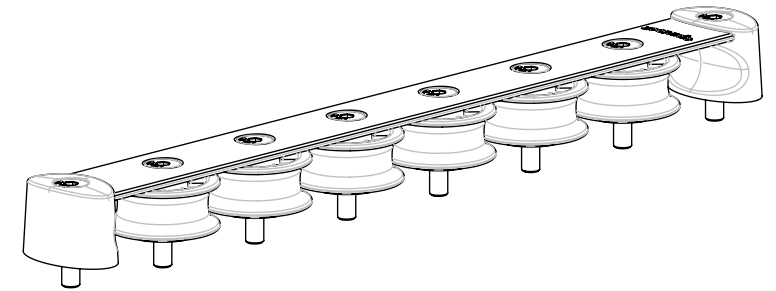

Ø 38 COMPOSITE SHEAVE (T38/6)
ALLOY SHEAVE (T38/6A)

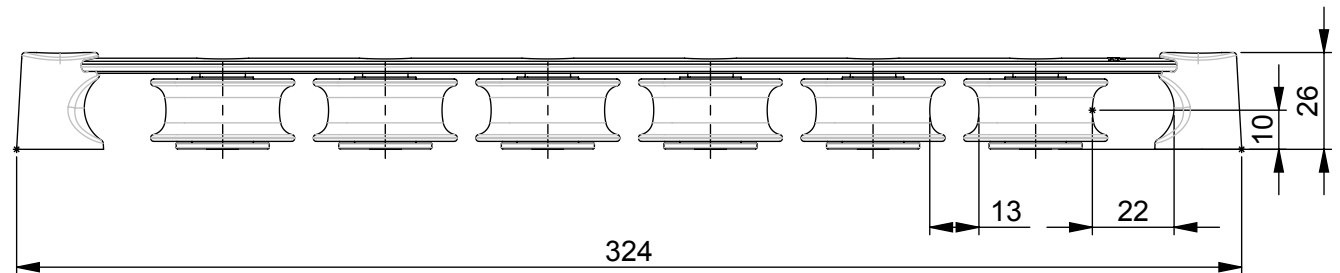
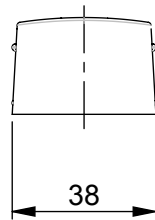
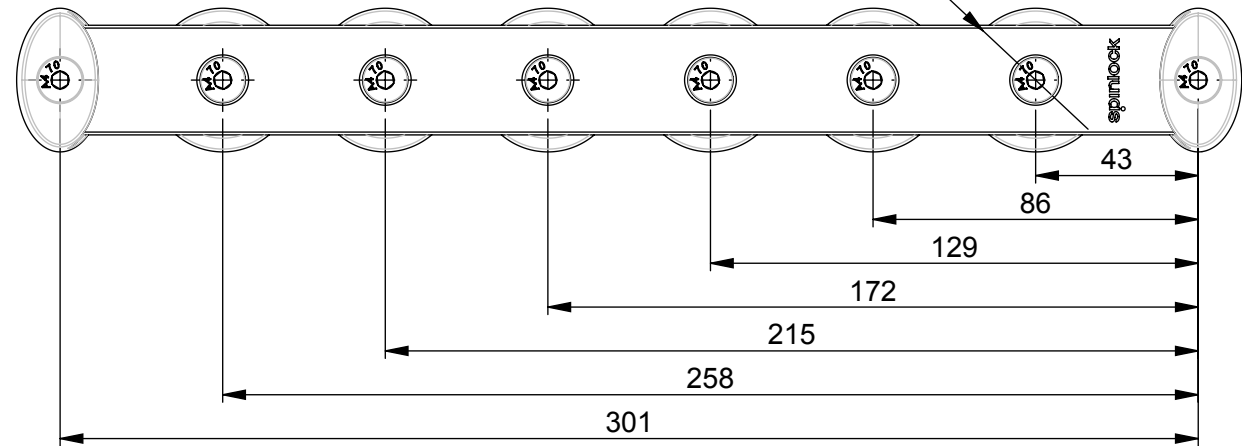

spinlock
BE ADVENTURE-PROOF



WARNING:
IF USING AS DRILL TEMPLATE, ENSURE PRINTER SETTINGS ARE ADJUSTED TO ACCOUNT FOR THE DRAWING SCALE AND **ALWAYS** CHECK DIMENSIONS BEFORE DRILLING.



COPYRIGHT:
THIS DRAWING IS PROTECTED BY COPYRIGHT. ANY USE IS FORBIDDEN WITHOUT THE WRITTEN CONSENT OF SPINLOCK.

ALL DIMENSIONS IN MM

SCALE PAGE SIZE DATE

1:2 A4 MAR 2018

LINE SIZE:
6-12mm
FASTENERS
M6 CSK
x 8

PRODUCT CODE

T38/6
T38/6A

WEIGHT

270g
379g

MAX LOAD

600kg
600kg

MAX LOAD PER UNIT

1800kg
1800kg

T38/6

FOR ANY MORE INFO CONTACT
SPT@SPINLOCK.CO.UK

DEFLECTION ANGLE

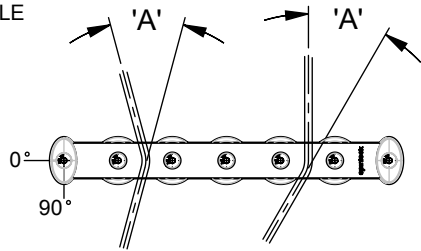

BISECTED ROPE ENTRY

STRAIGHT ROPE ENTRY

DEFLECTION ANGLE, 'A' (°)	MAX ROPE TENSION (KG)
10	3440
15	2300
30	1160
45	780
60	600
90	420

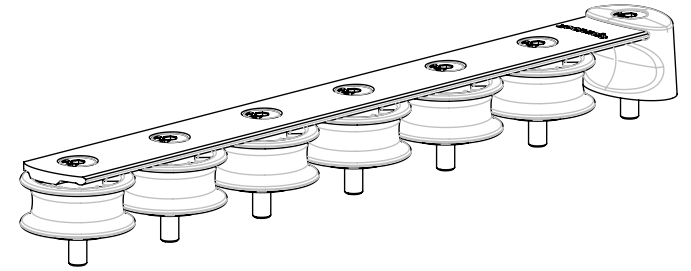

Ø 38 COMPOSITE SHEAVE (T38/6Y)
ALLOY SHEAVE (T38/6YA)

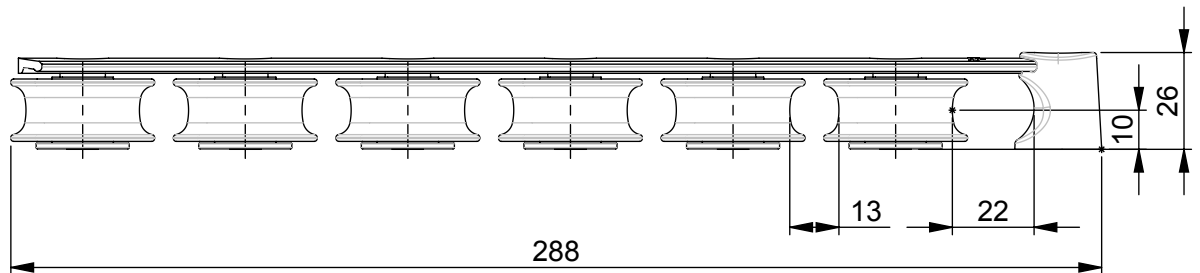
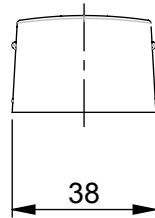
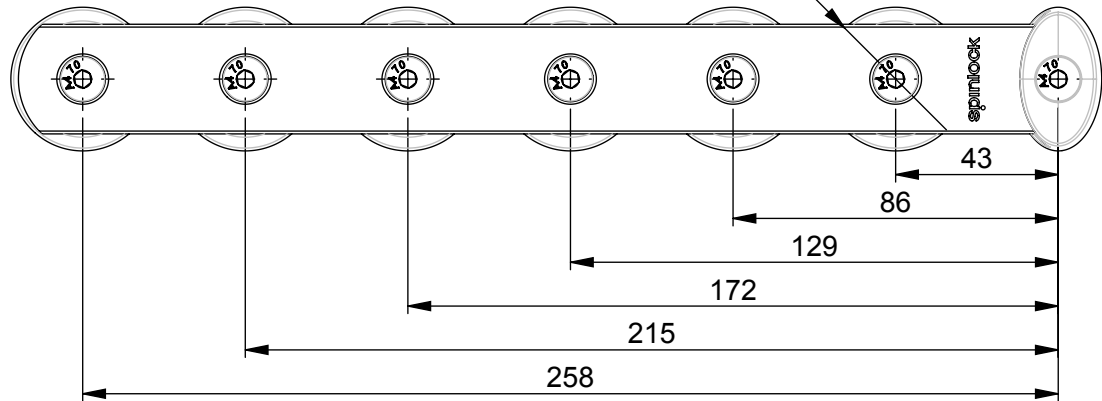

spinlock
BE ADVENTURE-PROOF



WARNING:
IF USING AS DRILL TEMPLATE, ENSURE PRINTER SETTINGS ARE ADJUSTED TO ACCOUNT FOR THE DRAWING SCALE AND **ALWAYS** CHECK DIMENSIONS BEFORE DRILLING.



COPYRIGHT:
THIS DRAWING IS PROTECTED BY COPYRIGHT. ANY USE IS FORBIDDEN WITHOUT THE WRITTEN CONSENT OF SPINLOCK.

ALL DIMENSIONS IN MM

SCALE PAGE SIZE DATE

1:2

A4

MAR 2018

LINE SIZE:
6-12mm
FASTENERS
M6 CSK
x 7

PRODUCT CODE

T38/6Y

T38/6YA

WEIGHT

243g

359g

MAX LOAD

600kg

600kg

MAX LOAD PER UNIT

1800kg

1800kg

T38/6Y

FOR ANY MORE INFO CONTACT
SPT@SPINLOCK.CO.UK